



LIANG CHI INDUSTRY (THAILAND) CO., LTD.

COUNTER FLOW INDUCED DRAFT LBC TYPE COOLING TOWER SPECIFICATION

DATE :
 TOWER MODEL NO. : LBC - T - 175
 NO. OF SETS : 1

DESIGN & OPERATING CONDITIONS

WATER FLOW RATE. : 1,956 LPM.
 HOT WATER TEMP. : 37 °C
 COLD WATER TEMP : 32 °C
 AMB. WET BULB TEMP. : 28 °C
 FAN B.H.P. : 4.17 BHP
 TOWER PUMP HEAD : 3.2 M
 DRIFT LOSS OF WATER FLOW RATE : 0.2 %
 EVAPORATION LOSS OF WATER FLOW RATE : 0.83 %
 DESIGN WIND LOAD : 150 Kg / M²

STRUCTURAL DETAILS

OVERALL DIMENSION : 3300 MM
 DRY WEIGHT : 713 Kg
 OPERATING WEIGHT PER TOWER : 2676 Kg

CONSTRUCTION

TOWER SUPPORTER FRAME ASS'Y : F.R.P.
 CASING : F.R.P.
 CASING SUPPORTOR : H.D.G.S.
 COLD WATER BASIN : F.R.P.
 FILLING : P.V.C.
 FILLING SUPPORTOR : H.D.G.S.
 FAN GUARD : H.D.G.S.
 MECHANICAL EQUIPMENT SUPPORTOR : H.D.G.S.
 INLET LOUVER : P.V.C.
 BOLTS,NUTS & WASHERS : C.P.S.

LIANG CHI IND. (THAILAND) CO., LTD.	
TECHNIC DEPT.	
<input type="checkbox"/>	FOR REFERENCE
<input checked="" type="checkbox"/>	FOR APPROVAL
<input type="checkbox"/>	APPROVED
<input type="checkbox"/>	OTHER.....
DATE :	
TECHNIC BY :	



LIANG CHI INDUSTRY (THAILAND) CO., LTD.

COUNTER FLOW INDUCED DRAFT LBC TYPE COOLING TOWER SPECIFICATION

WATER DISTRIBUTION

STAND PIPE : P.V.C.
 SPRINKLER HEAD : A.A.
 MODEL : LSH - 125
 SPRINKLER PIPE : P.V.C.

MECHANICAL EQUIPMENTS

FAN UNIT

NO. OF UNIT : 1 UNIT / SET
 TYPE : AXIAL FLOW
 MODEL : LSF-180
 MANUFACTUROR : LIANG CHI IND.CO.,LTD.
 DIAMETER : 1750 MM
 NO. OF BLADES : 4
 FAN SPEED : 575 RPM
 TIP SPEED : 52.7 M/S
 BLADE MATERIAL : A.A.
 HUP MATERIAL : A.A.
 AIR VOLUME : 1150 M³ / MIN/SET

FAN MOTOR

NO. OF UNIT : 1 UNIT / SET
 TYPE : TEFC
 INSULATION : CLASS F IP55
 MANUFACTUROR : LIANG CHI
 SPEED : 575 RPM
 RATED H.P : 5 H.P * 10P
 POWER SOURCE (VOLT / PHASE / HZ) : 380 / 3 / 50

LIANG CHI IND. (THAILAND) CO., LTD.	
TECHNIC DEPT.	
<input type="checkbox"/>	FOR REFERENCE
<input checked="" type="checkbox"/>	FOR APPROVAL
<input type="checkbox"/>	APPROVED
<input type="checkbox"/>	OTHER.....
DATE :	
TECHNIC BY :	



LIANG CHI INDUSTRY (THAILAND) CO., LTD.

COUNTER FLOW INDUCED DRAFT LBC TYPE COOLING TOWER SPECIFICATION

<u>PIPING CONNECTION</u>		SIZE		Q'TY / SET
WATER INLET	:	5	B (125 A)	1
WATER OUTLET	:	5	B (125 A)	1
AUTO FILL	:	1	B (25 A)	1
QUICK FILL	:	1	B (25 A)	1
OVER FLOW	:	2	B (50 A)	1
DRAIN	:	2	B (50 A)	1

REMARK

F.R.P : FIBERGLASS REINFORCE PLASTIC

H.D.G.S : HOT DIP GALVALNIZED STEEL

A.A. : ALUMINIUM ALLOY

C.P.S. : CHROMATED - PLATING STEEL

DESIGNED :.....

CHECK :.....

APPROVE :.....

LIANG CHI IND. (THAILAND) CO., LTD.	
TECHNIC DEPT.	
<input type="checkbox"/>	FOR REFERENCE
<input checked="" type="checkbox"/>	FOR APPROVAL
<input type="checkbox"/>	APPROVED
<input type="checkbox"/>	OTHER.....
DATE :	
TECHNIC BY :	

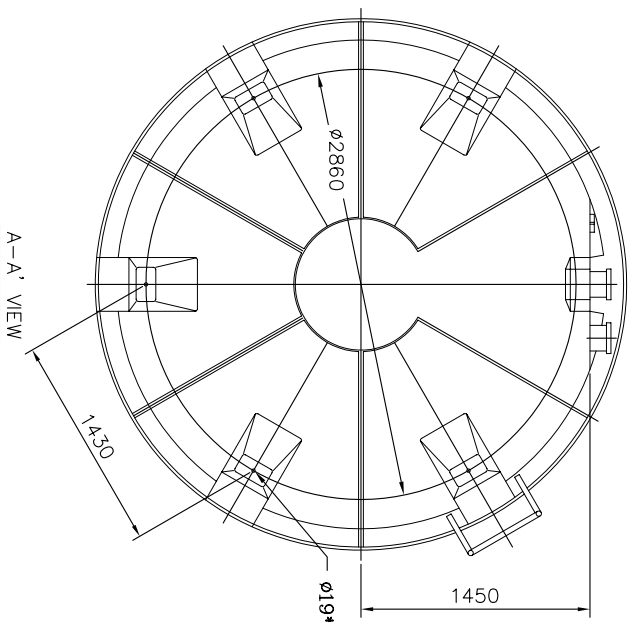
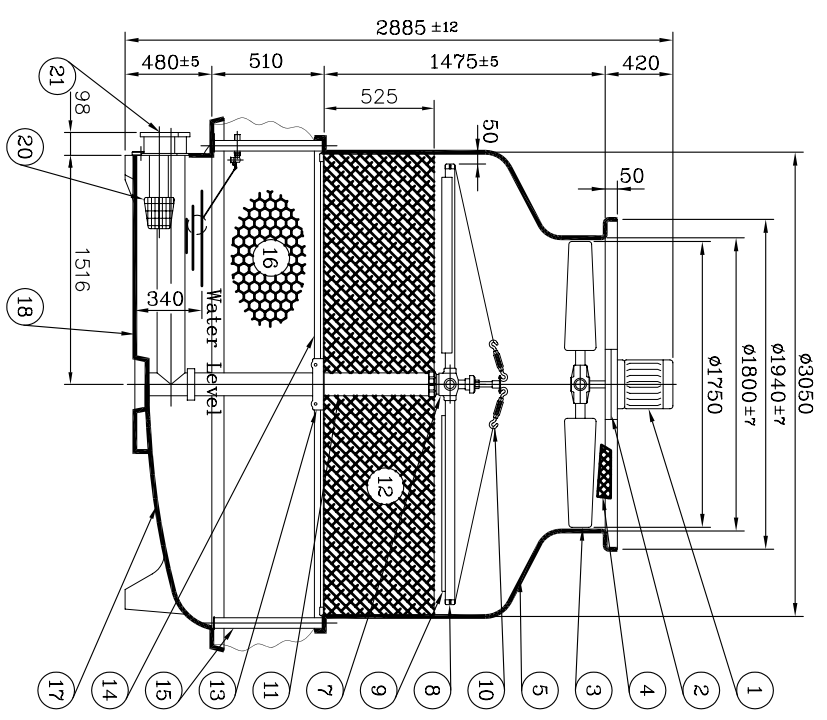
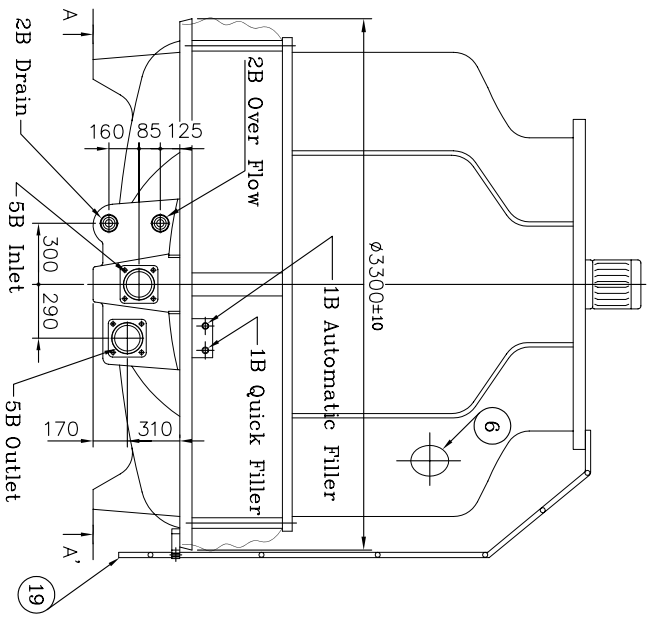

Ø19*5 Holes For Expansion Bolt

LIANG CHI IND. (THAILAND) CO.,LTD
TECHNIC DEPT.

FOR REFERENCE
 FOR APPROVAL
 OTHER.....

DATE:

TECHNIC BY:

- Abbrev. : 1. H.D.G.S.:Hot Dip Galvanized Steel
2. A.A. : Aluminum Alloy
3. S.T.S :Stainless Steel 304
4. F.R.P. :Fiberglass Reinforced Plastic

Description	M.T	Specification	Q'ty
1 Fan Motor		5HP*10P	1 PCS
2 Motor Framework Ass'y	H.D.G.S		1 PCS
3 Fan	A.A.	LSF-180	1 SET
4 Fan Guard	H.D.G.S.		1 SET
5 Casing	F.R.P.		6 PCS
6 Hand Hole	E.V.A		1 PCS
7 Sprinkler Head	A.A.	LSH-125	1 PCS
8 Sprinkler Pipe	P.V.C.		4 PCS
9 Eliminator	F.R.P.		4 PCS
10 Tension Device	P.V.C.		4 SET
11 Stand Pipe	P.V.C.		1 PCS
12 Filling	P.V.C.		1 SET
13 Stopper or Column	H.D.G.S		1 SET
14 Filling Supporter	H.D.G.S		1 SET
15 Casing Supporter	H.D.G.S		6 PCS
16 Inlet Louver	P.V.C.		1 SET
17 Water Basin	F.R.P.		5 PCS
18 Water Sump	F.R.P.		1 PCS
19 Ladder	H.D.G.S		1 PCS
20 Strainer	P.E.		1 PCS
21 Flange	H.D.G.S		2 PCS

Drain	50A (2 B)	Over Flow	50A(2 B)
Outlet	125A (5 B)	quick filler	25A(1 B)
Inlet	125A (5 B)	Automatic filler	25A(1 B)
Pipe Connections			
Dry Weight	713 kgs	Operating Weight	2,676 kgs
Loading Data			
Ambient Wetbulb	: 28 °C	Air Volume	: 1,150 M ³ /MIN
Outlet Water Temp	: 32 °C	Water Flow	: 1,956 LPM
Inlet Water Temp	: 37 °C	Cooling Capacity	: 586,800 Kcal/HR

Design Condition

REV.	DATE	DWG BY	APP.	NOTE
		LBC-T-175		
TITLE				
OUTLINE VIEW				
APP.	K.Somnans	DESIGN	Annat	MM
CHECK	SURASAK	DWG BY.	Annat	DWG-NO
LIANG CHI INDUSTRY (THAILAND) CO., LTD. 223 Moo 9 Tab-YaoLad-KRABANG BANGKOK 10520 (NUM KRAL INDUSTRIAL ZONE LUANG-PAENG RD.)				LBC-T-175-01

EXPANSION BOLT (BY LIANG CHI)

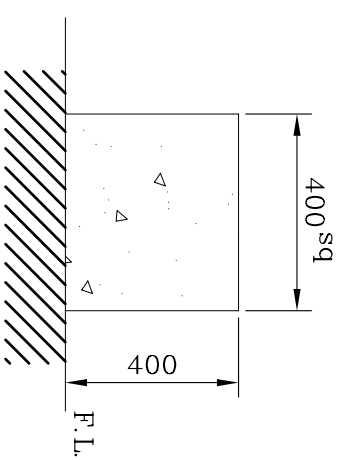
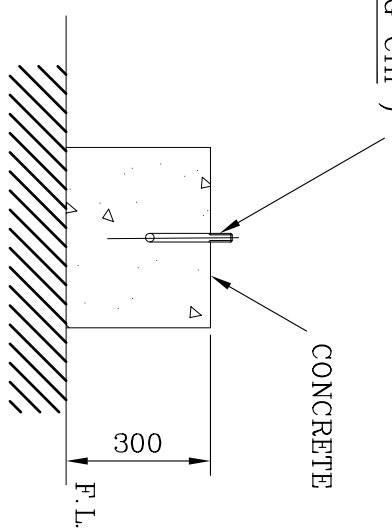
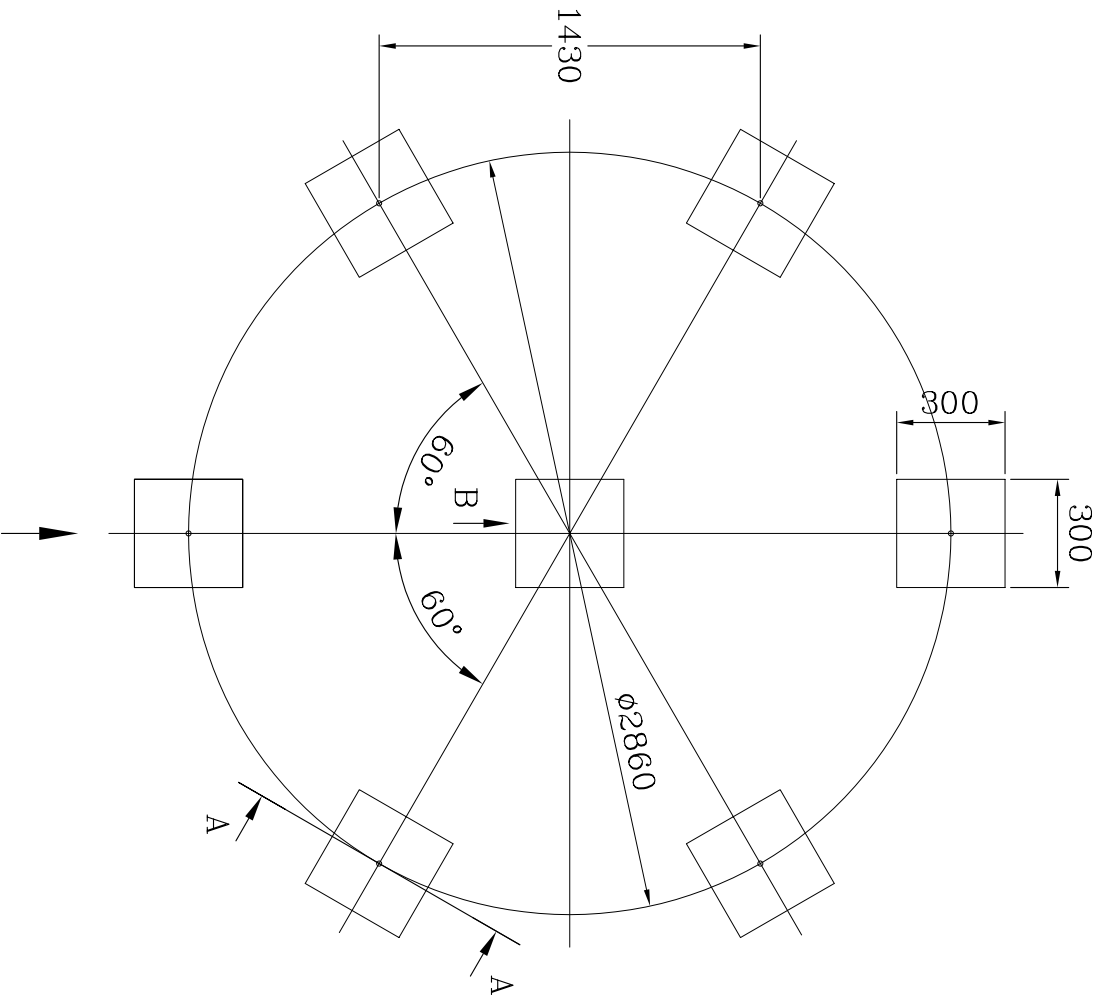

REMARK :

1. THIS FOUNDATION DRAWING IS PROVIDED FOR END USER'S REFERENCE.
2. COOLING TOWER DOES NOT INCLUDE FOUNDATION
3. THE LEVEL TOLERANCE OF FOUNDATION IS ± 2 mm.
4. THE HEIGHT OF FOUNDATION EXCLUDES THERMAL ISOLATOR AND WATER PROOF.
- * 5. EXPANSION BOLT & RUBBER PAD SHALL BE FURNISHED BY LIANG CHI
(PLEASE DON'T PREPARE HOLE OF EXPANSION BOLT BEFORE INSTALLATION)

Water Inlet

LIANG CHI IND. (THAILAND) CO.,LTD
TECHNIG DEPT.

FOR REFERENCE
 FOR APPROVAL
 APPROVAL
 OTHER.....

DATE:

TECHNIC BY:

REV.	DATE	DWG BY	APP.	NOTE
LBC-T-175				
Concrete Foundation				
APP.	K.Somnans	DESIGN	Annat	
CHECK	SURASAK	DWG BY.	Annat	
LIANG CHI INDUSTRY (THAILAND) CO., LTD. 223 Moo 9 Tab-Yaolad-Krabang Bangkok 10520 (NUM KRAL INDUSTRIAL ZONE LUANG-PAENG RD.)				
				MM
				X
				DWG-NO
				LBC-T-175-02

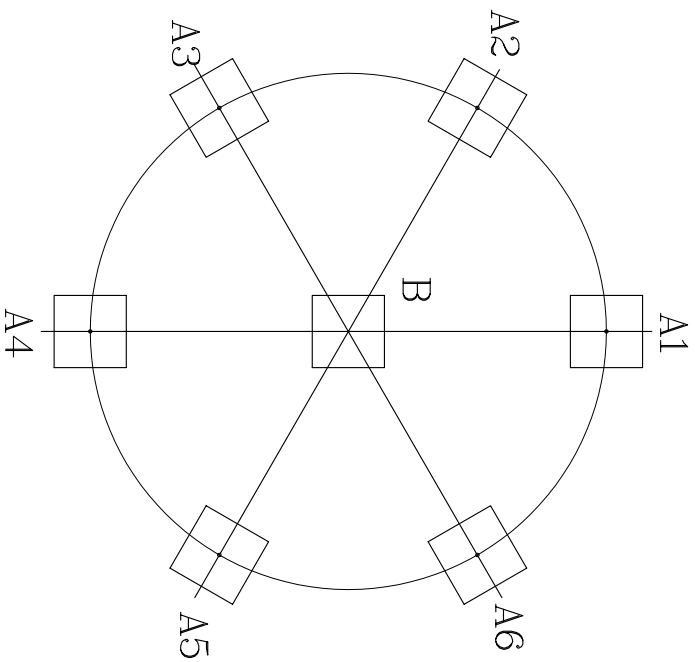

UNIT : KG.

LBC-T-175	A1=A2=...=A6	B
	210	1,416

LIANG CHI IND. (THAILAND) CO.,LTD

TECHNIC DEPT.

FOR REFERENCE

FOR APPROVAL

APPROVAL

OTHER.....

DATE :

TECHNIC BY :

REV.	DATE	DWG BY	APP.	NOTE
TITLE		LBC-T-175		
		Loading Data		
APP.	K.Somnani	DESIGN	Annat	MM
CHECK	SURASAK	DWG BY.	Annat	<input checked="" type="checkbox"/>
				DWG-NO
LIANG CHI INDUSTRY (THAILAND) CO., LTD. 223 Moo 9 TAB-YAO LAD-KRABANG BANGKOK 10520 (NUM KRAI INDUSTRIAL ZONE LUANG-PAENG RD.)				LBC-T-175-03